

---

## FRP Installation Instructions

---

ARTIZAN™ FRP  
SYMMETRIX™ FRP

ENVUE™ FRP  
STANDARD™ FRP

Statements expressed in this technical bulletin are the recommendations for the application of Marlite brand products as outlined and illustrated under normal conditions of installation. The recommendations provided in the bulletin represent our best judgement based on our experience with normal applications. Unless prior approval is obtained in writing from Marlite, any deviation from these recommended procedures shall be at the sole risk of the installers. Carefully inspect all panels. If a panel is defective, notify the Marlite Service Center nearest you at once. Failure to do so shall be at the sole risk of the installer.

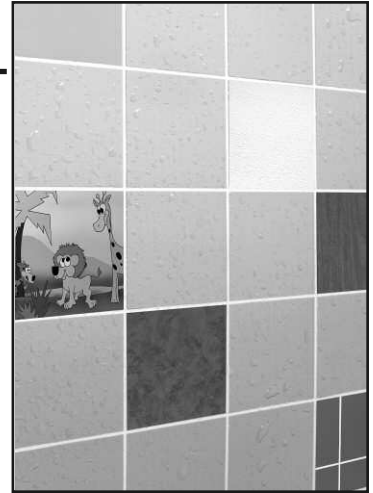

**Important** - Read complete instructions carefully before you begin application.

**Total System Components** - Nominal 3/32" thick, 4' wide panels, harmonizing PVC moldings, adhesives, silicone sealant and Marlite Brand Patented FRP Base Molding System.

**Tools Required** - Power saw (carbide tip) or saber saw (metal cutting blade). Fine tooth handsaw-keyhole saw, caulking gun, rule/tape, drill, file, hammer, plumb line/level, horses and supports.

**Caution** - Protect your eyes with goggles, cover your nose and mouth with filter mask when cutting FRP products.

**Cleanup** - Use a damp cloth, mild soap or detergent to clean panels. Use mineral spirits to remove excess adhesive or silicone. Do not use abrasive cleaners. Can be jet spray washed.

**Open Package** - Carefully inspect all panels. Due to texture and manufacturing techniques, some panels may vary in color consistency and pattern.

---

### Installation Tips

1. Install when room temperature and material temperature is at 70°F.
  2. Application recommended to solid backing, such as plywood or drywall. Surface to be covered must be clean, dry, solid, straight and free from drywall dust, bumps, projections, loose plaster or paint.
  3. Maintain plumb vertical edges with plumb lines or level.
  4. Do not make FRP panel joints directly over drywall or plywood joints.
  5. Cut panels face down with handsaw or face up with table saw.
  6. When using Marlite Brand C-551 FRP Adhesive, use only unfinished/untreated plywood or unfinished/untreated drywall.
- 

### Condition Panels

The panels should be allowed to acclimate to the room environment prior to installation. After unpacking, place panels in the room where they will be installed for at least 48 hours prior to installation.

---

### Important! Regarding high humidity areas:

For applications that require sealant we recommend the use of Marlite Brand Silicone Sealant, available in clear (MS250) or white (MS251). In high moisture or wet areas, moldings should surround all panels and be properly sealed with a continuous bead of sealant.

## Proper Adhesive Technique

Always apply Marlite Brand C-551 FRP Adhesive or Marlite Brand C-375 Construction Adhesive to the panel back. Be sure the existing subwall is porous, straight, clean and dry, such as drywall or plywood.

**If the subwall is non-porous, you must use Marlite Brand C-375 Adhesive and perform a trial to be sure you have acceptable adhesion and performance.** Adhesive is easier to spread at 70° F. Panels must be installed while adhesive is fresh (within 10 minutes). Adhesives on panel face should be removed promptly with mineral spirits. Coverage: 210 square feet per 3.5 gallon can.

- Apply adhesive to the entire back of panel using the notched spreader provided. (100% coverage over entire back of panel except approximately 1" at edges). Use the notches in the spreader to get the exact depth of adhesive. Avoid too heavy a coat. (Refer to ill. 1-A). To assure proper ridges when spreading, keep notches of spreader clean by placing spreader in a pail of water when not in use.

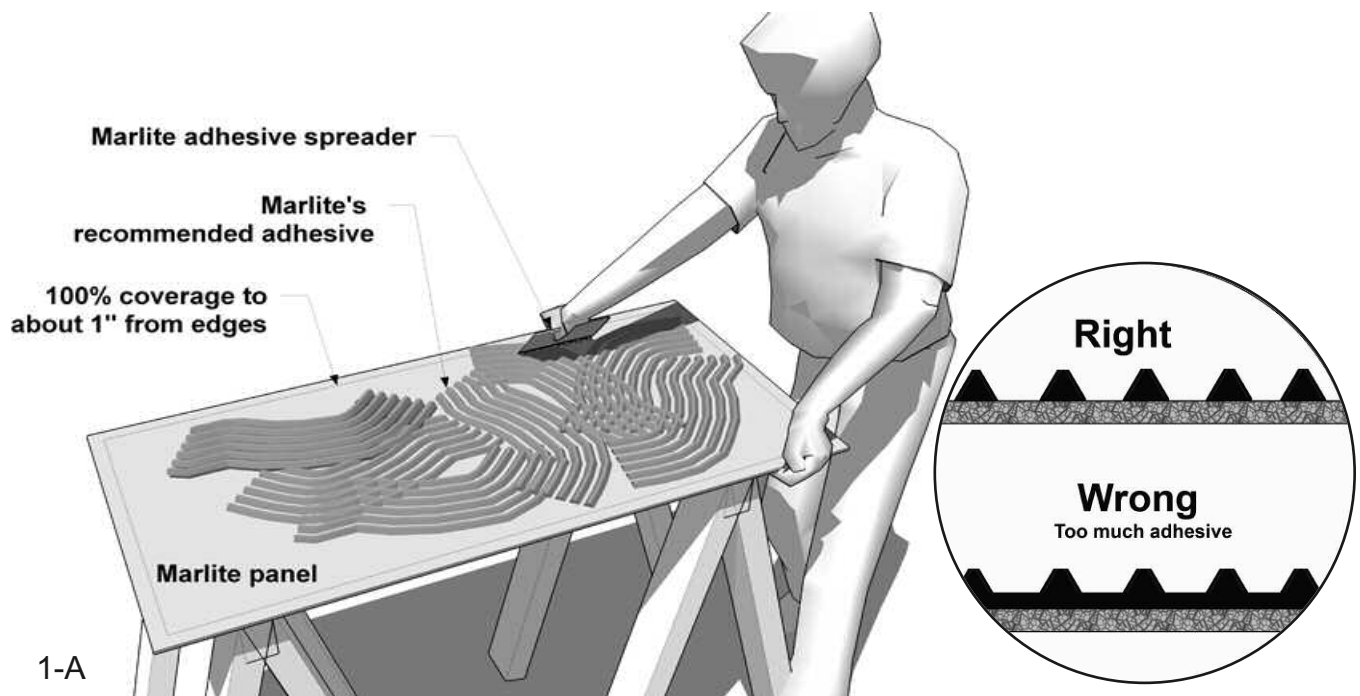

**Special Hints** - Use Marlite Brand C-551 FRP Adhesive (Latex based) for low V.O.C. requirements.

Pouring a layer of water on top of Marlite Brand C-375 Construction Adhesives in the can keeps adhesive fresh, reduces solvent odor, extends open time and eases cleaning of spreader.

Alternative technique for faster C-375 bonding strength development, apply a normal coat of adhesive with spreader to the panel. Immediately press the panel against the wall and pull back completely. Immediately reposition the panel carefully back in place.

**NOTE: The use of cartridge adhesives will not allow panels to stay flat and tight to the wall. DO NOT USE.**

**Mechanical Fasteners** - Unusual situations may require drive rivets 16" on center. Work from top to bottom or middle to edges. Drill holes for fasteners 1/8" oversize to allow for panel expansion. For best bonding, arrange fasteners on 16" centers with outer fasteners about 1" from panel edge. Where panels butt together, fasteners should be staggered to insure a flat seam.

# Installation Steps for Panel Molding

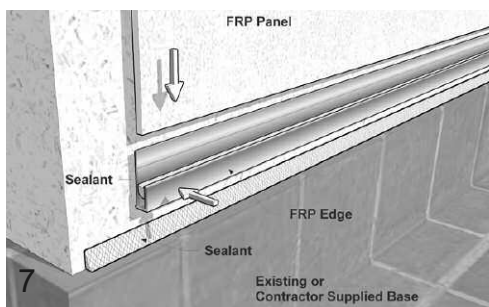
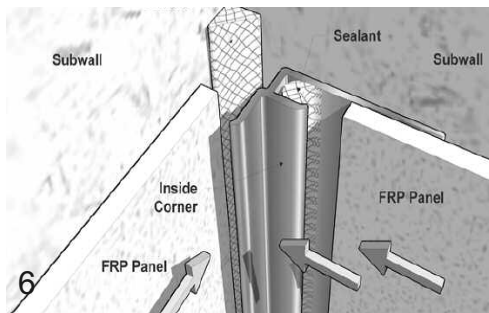
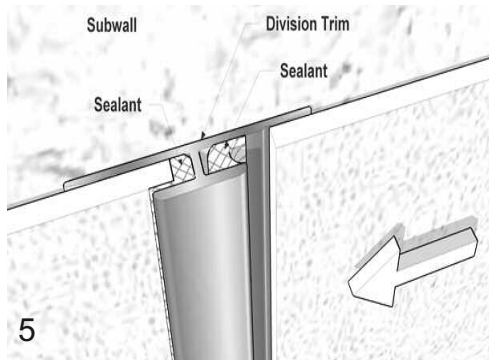
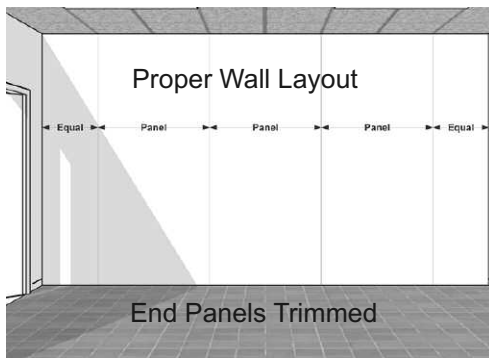
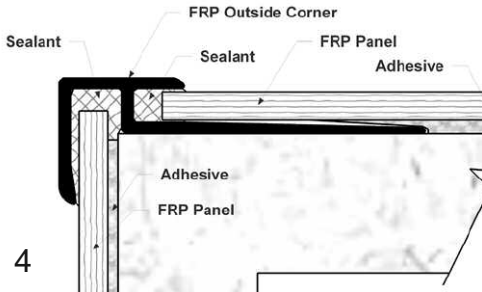
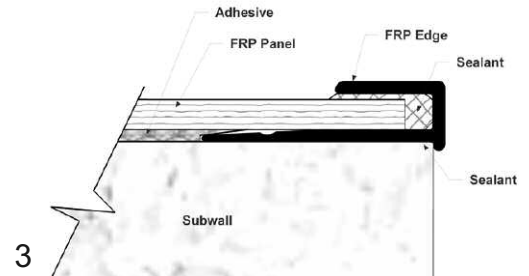
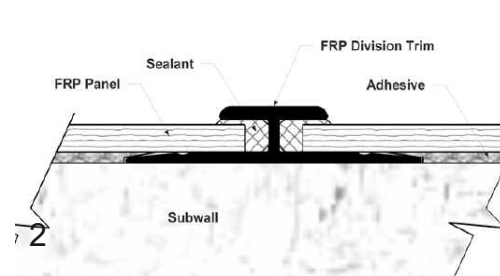
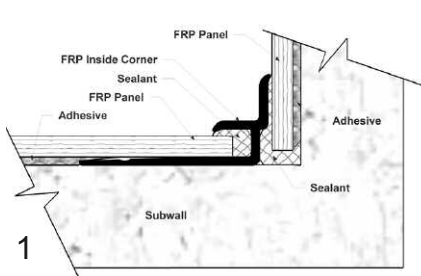

1. For a balanced appearance establish the center line of area to be covered and install division molding and work to corners. (see ill. 5)

2. Moldings can be applied by coated lath nails and/or adhesive. If nails only are used, backing material must have nail holding capabilities or nails must be long enough to penetrate into furring or framing. Do not nail through panels.

3. Moldings should surround all edges of every panel.

4. Do not fit panels too tightly in moldings. Allow at least 1/8" in all channels for panel expansion after installation is completed. See back page for proper adhesive selection and application.

5. Where steam cleaning is required and high moisture conditions are prevalent, all moldings and panels must be sealed with Marlite Brand Silicone Sealant to insure a watertight seal. (see ill. 1-4)

6. Sealant can be best applied to moldings prior to application to wall. It is important that continuous, non-broken beads of sealant be applied. Excess sealant "squeeze out" should be promptly cleaned off with mineral spirits.

7. It is suggested that a sealant be applied to all exposed edges of moldings, electric plates and other covers after installation. Allow 24 hours drying time for sealant.

8. Rough cut edges can be smoothed with sandpaper or file.

## Application at Inside Corners

Apply a continuous bead of sealant at corner and in the molding channel. Secure inside corner molding to cover bead. (see ill. 6)

## Application to Tile Curb, Floor, Base Molding or Ceiling Line

Curb must be installed first. Apply a continuous bead of sealant to top of curb or floor line and in the molding channel. Seat edge molding in place and fasten to subwall. Slip panel into molding. Allow for 1/8" expansion and sealant "squeeze out". (see ill. 7) Similar application at ceiling line.

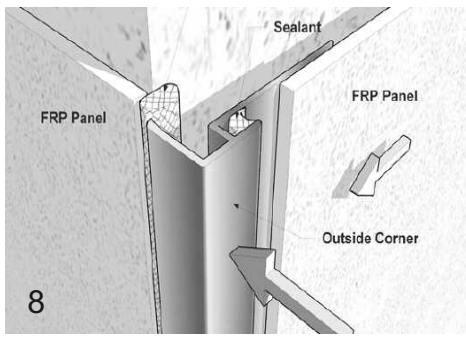

## Application to Outside Corner

First, cut final panel on preceding wall flush to outside corner and install. Apply a continuous bead of sealant to both molding channels. Secure in place. Slip in next panel. (see ill. 8)

M961 Outside Corner Guard is also available for areas that require more durability, or use F560SS snap on Stainless Steel Corner Guard.

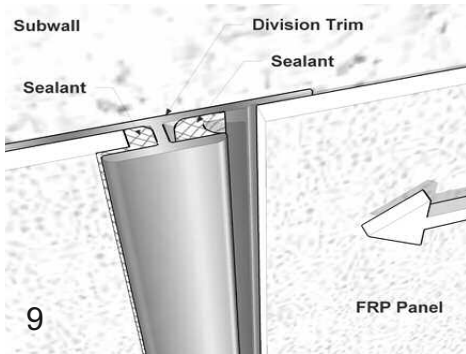

## Application to Division Molding

Apply a continuous bead of sealant to both channels. Slip under preceding panel (see image 9) and secure to wall. Then continue with next panel.

Flanges and posts of Division Molding must be cut away 3/4" if it butts to already applied moldings. (see ill. 10)

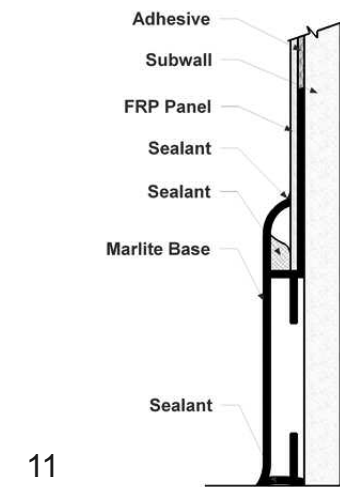
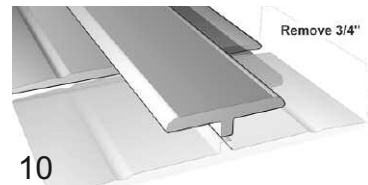

## Application of Patented FRP Base Molding

1. Locate the highest point of the floor and mark a level reference line around the room to guide installation.

2. Start at door opening. Apply 1/4" bead of Marlite Brand MS250 clear Silicone Sealant to top, face and bottom of end cap. (see image 12) Attach end cap to base molding. CAUTION: A sufficient amount of sealant must be applied to have some "squeeze out" to insure a moisture proof seam when end cap is attached to base molding.

3. Apply a 1/4" bead of Marlite Brand MS250 clear Silicone Sealant to the bottom of base molding. CAUTION: A sufficient amount of sealant must be applied to have some squeeze out when base molding is set in place.

4. Set base molding in place using Marlite Brand MS250 clear Silicone Sealant and nail through back flange every 24" using 1-3/8" drywall nails. (see ill. 11)

5. Continue to install base molding using Marlite Brand MS250 clear Silicone Sealant to attach butt joint connectors, inside corners and outside corners to base molding. (see ill. 13-15)

**NOTE:** Apply a 1/4" bead of sealant to top, face and bottom of all male connectors. (see image 12-15)

6. Apply 1/2" bead of sealant in channel of molding as panels are installed.

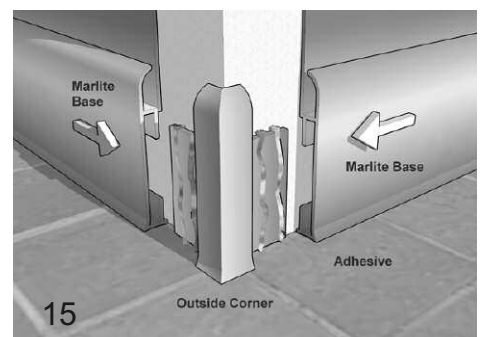
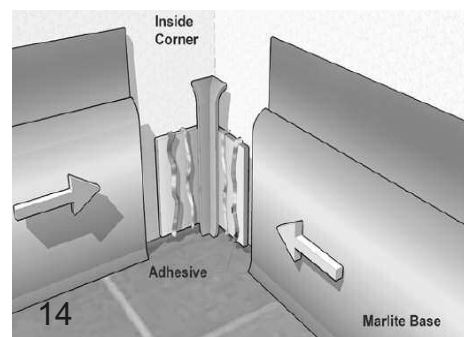
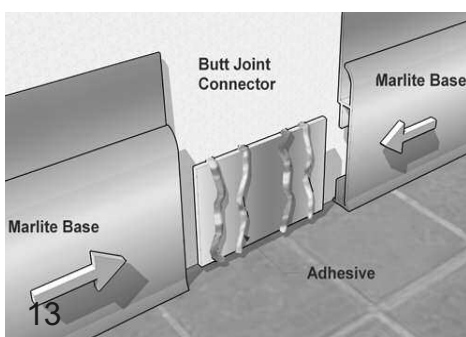
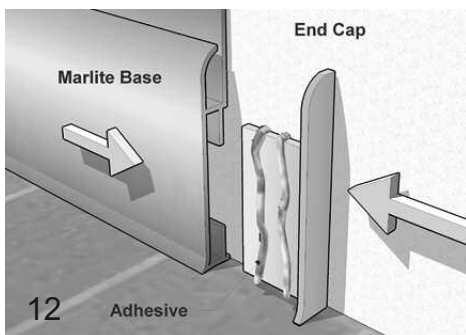

## Seam Joint Installation

Artizan Grooved Panels and Symmetrix FRP panels

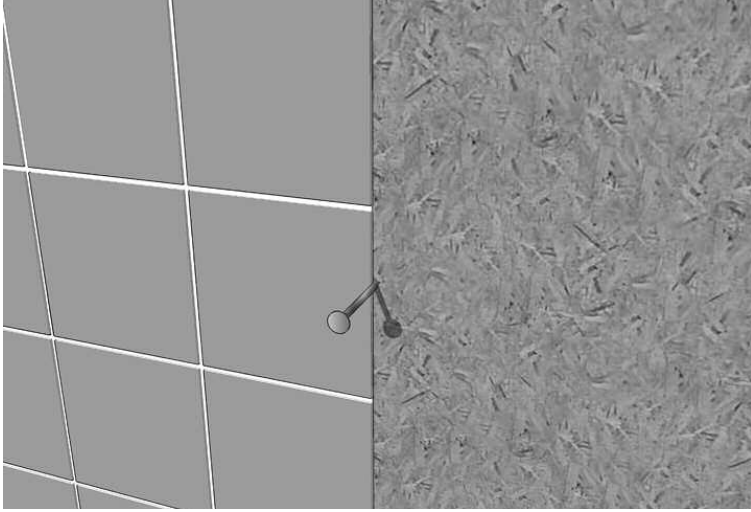

1. Place a 6 penny spacing nail between panels.

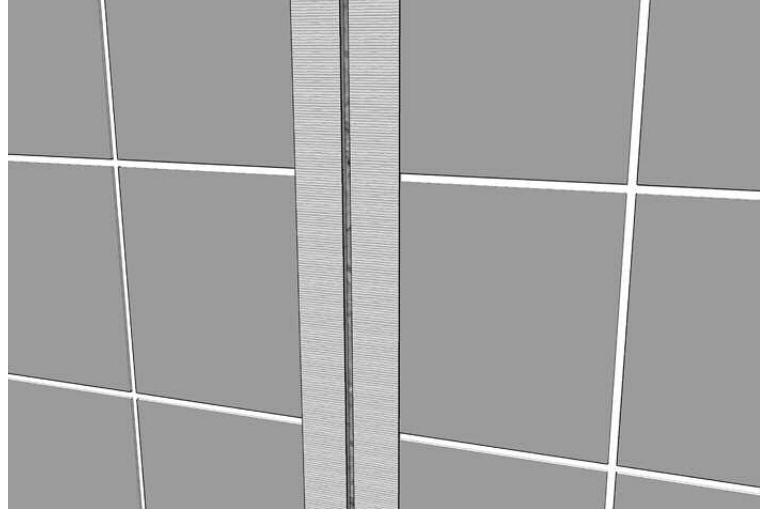

2. Remove nail and protect panel face with tape.  
Wait one hour for adhesive to cure.

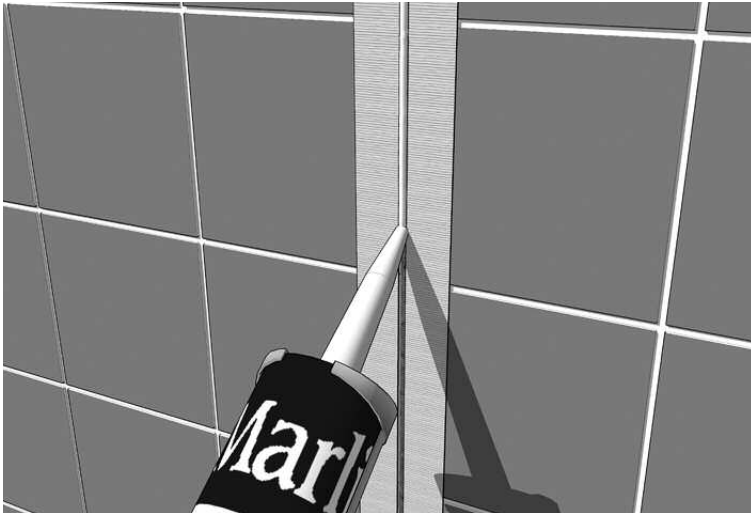

3. Place a bead of harmonizing Marlite Silicone Sealant in the gap.

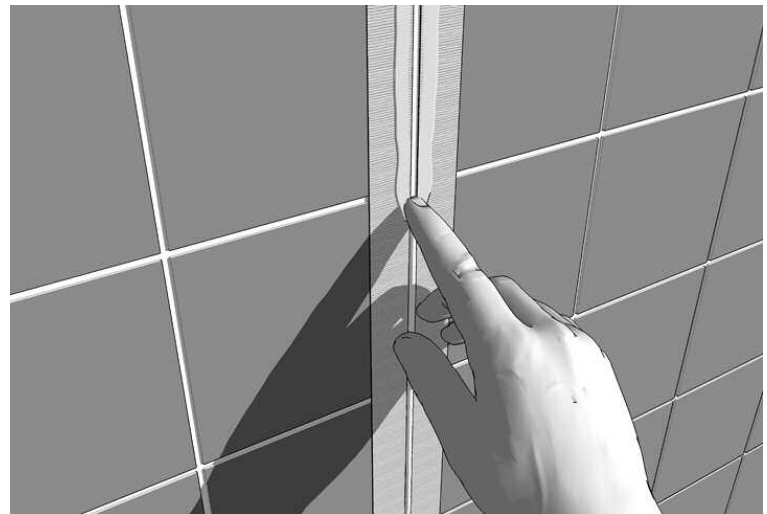

4. Using your finger, place a slight indentation in the gap.

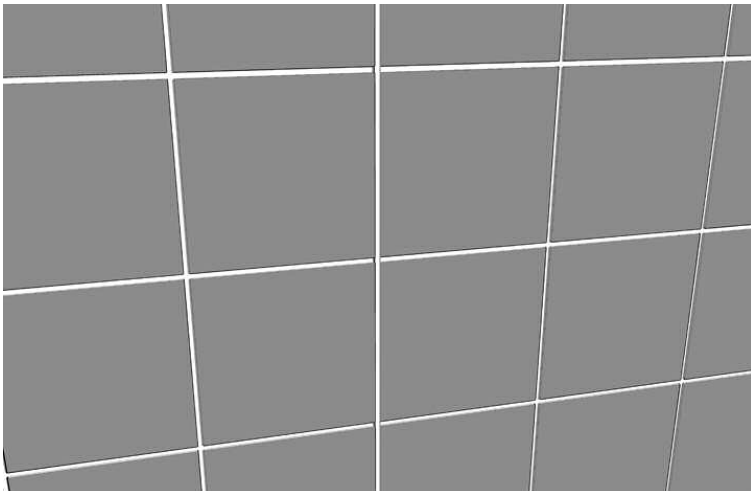

5. Remove the tape to reveal a grooved and matched seam joint.



Dover, Ohio 44622 • 330-343-6621  
[www.marlite.com](http://www.marlite.com) • [info@marlite.com](mailto:info@marlite.com)

Form No. FR19-10042  
Effective Date 10-01-08

Copyright 2008