



Sieva® Large Panel Wall System Installation Instructions

General Notes & Product Information

Product profiles & details may vary by installation. Consult architectural drawings, details & specifications before installation of any Marlite products.

Notice: Statements expressed in this technical bulletin are the recommendations for the application of the Marlite brand products as outlined and illustrated under normal conditions of installation. The recommendations provided represent our best judgement, based on our experience with normal applications. Unless prior approval is obtained in writing from Marlite, deviation from these recommendations shall be at the risk of the installer(s).

Preparation: Building must be closed and HVAC systems operational and balanced. Concrete, paint drywall compounds and other sources of humidity must be dry and cured. Structural walls must be flat & true. A subwall surface is recommended, such as drywall, plywood or OSB. Vapor barriers are required between wall framing and subwall surface for exterior walls, to discourage warping. Direct, repetitive and continuous exposure to HVAC ventilation, extreme temperatures and/or direct sun exposure can result in a detrimental effect to the panels. Such conditions should be corrected before product installation. Except as approved by the manufacturer, most Marlite products should not be installed in high-humidity areas, such as kitchens, restrooms, showers & cold storage areas. Protect exposed floor & wall areas from damage with drop-cloths & rigid cardboard or plywood.

Conditioning: Panels must be allowed to equalize to the building conditions before installation. Acclimation in the installation area of at least 48 hr. is recommended. To ensure product performance, temperature range of 60-80° F and humidity range of 35-55% is recommended during storage, installation and product life cycle.

Handling: Open cartons and inspect all panels & hardware for damage. If material is found defective, notify Marlite immediately. Failure to do so will be at the sole risk of the installer(s). Store panels in a dry environment similar to final installation conditions. Store panels flat and off concrete floors. Color & texture variations may result from manufacturing techniques. Care must be taken during installation to check panel match before installing. Contact Marlite with questions.

Caution: Always wear eye protection and proper protective gear. Use proper safety guards on equipment during fabrication and installation. Note: Metal veneers & hardware can spark or produce sharp metal chips.

Tools: Regular carpentry tools, such as table, miter, circular & jig saws, sanding blocks & fine files, appropriate bubble level or laser level, chalk line, carpenter's square, etc. Use medium fine tooth carbide blades for cutting. When cutting solid phenolic panels, keep feed speed up to prevent blade overheating and damage.

Fabrication: Cut panels "face up" on a table saw or "face down" with a hand-held circular or jig saw. Use a sanding block or fine file to remove burrs or break sharp edges. Refinish exposed panel edges to match factory edges. NOTE! For all cutouts in HPL Panels, rounded inside corners (1/8" minimum radius) will minimize stress cracking. Trim & hardware are easily cut & mitered using carbide tipped blades in power miter and table saws. Pre-drilling of rim & hardware for attachment is not required if drill-tip screws are used. Where adhesive is needed, Marlite brand adhesives are required. Others may be substituted, Marlite approval. Follow manufacturer's use & clean-up recommendations for adhesives.

Clean-up: Most Marlite panels, trim & hardware are easily cleaned & maintained using a soft cloth and appropriate spray on cleaner or polish. Dampen cloth with cleaner. Don't over saturate cloth or not spray directly on products. To clean adhesive from most panels and all hardware & trim follow the adhesive manufacturer's recommendation. Always test any cleaner or thinner on a scrap piece of panel before proceeding.

For questions regarding product or installation issues, contact: Marlite at 1.800.377.1221 or contact your local territory manager.

Large Panel Fabrication

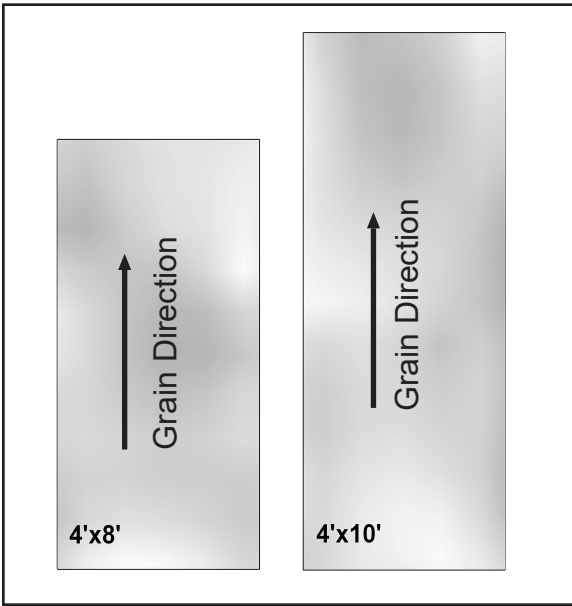

Panel Sizes:

Marlite's Large Panels are supplied in:

4'x8' (nominal)

4'x10' (nominal)

Cut to Size*

Field fabrication is required for sizes other than listed.

*For cut to size panels: customer must provide take off of panel size quantities.

Panel Cutting

Sieva panels are easily cut to fit field condition.

Cut "face up" when using a table saw.

Cut "face down" when using a circular saw. Pad support surfaces if cutting face down.

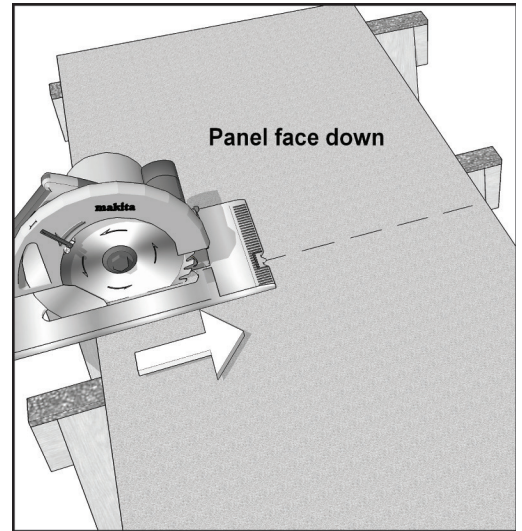
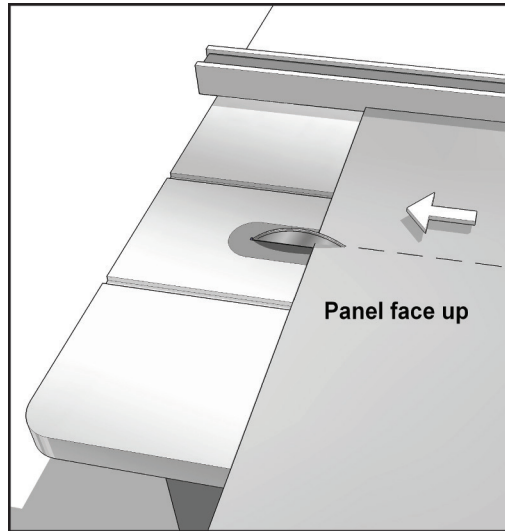

Kerfing Edge and Face Dado

It is necessary to groove or "kerf" the edge of the panels after field cutting to accommodate LP551 Slim Reveal hardware. The kerf is 1/8" wide and can be made using a hand-held router with the appropriate bit. Kerf depth and router set-up should be checked by matching to a factory kerfed edge.

It is necessary to dado the face of the panel after field cutting to accommodate LP552 Narrow Reveal hardware. The dado is 1/8" wide x 1/8" deep and can be made using a hand-held router with the appropriate bit. Dado depth and width and router set-up should be checked by matching to the factory dadoed edge.

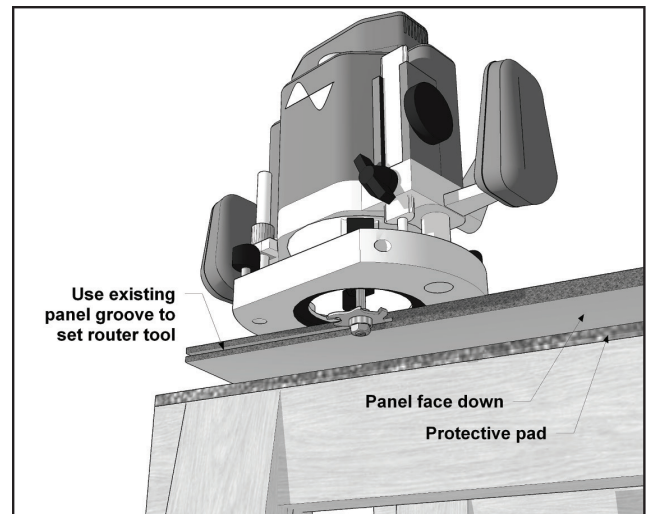

Router bits for the kerf and dado can be ordered from Marlite and shipped with your Sieva Large Panel System order. Or contact Marlite toll free at 1.800.377.1221 to order additional router bits.

GENERAL NOTE! NEMA LD-3 SECTION A.7

TYPICAL PROBLEMS- CAUSES AND PREVENTION

- A. Stress cracking - Cracking of the laminate at corners and around cutouts (see Figure A-9) may be caused by improper fabrication during installation. Rough edges, inside corners that have not been radiused, and forced fits can cause cracking. Radiusing all edges and inside corners as large as possible 3 mm (1/8 in.) minimum will minimize stress cracking. A radiused corner created by a 6 mm (1/4 in.) diameter router bit is normally used.

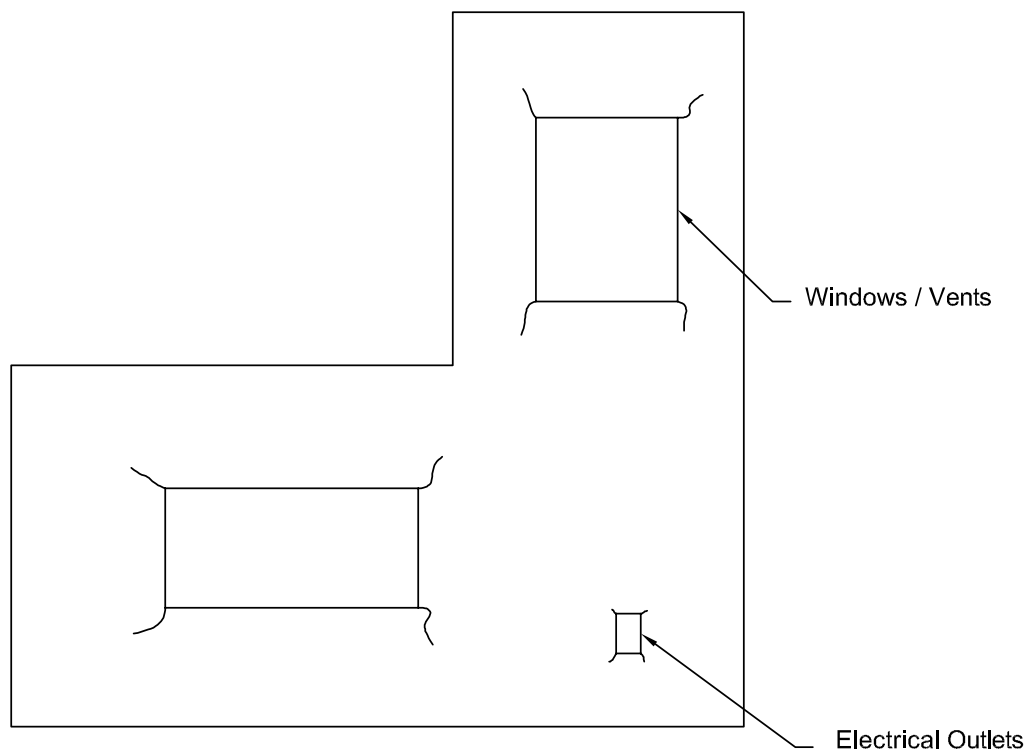
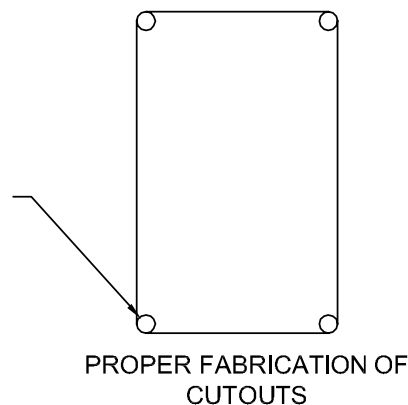

FIGURE A-9
CRACKING OF LAMINATE

NOTE! To help prevent stress cracking of the laminate, pre-drill all four corners using a 1/4 " bit. Do not square the corners.



Sieva Large Panel Installation Steps

Large Panel System Installation - 1

Before proceeding, read and understand all installation instructions and details. No installation instructions can cover every field condition, therefore installers are expected to have reasonable knowledge and tools to interpret and adapt these instructions to varying field conditions and situations. Questions and concerns regarding special conditions can be directed to Marlite at 1.800.377.1221.

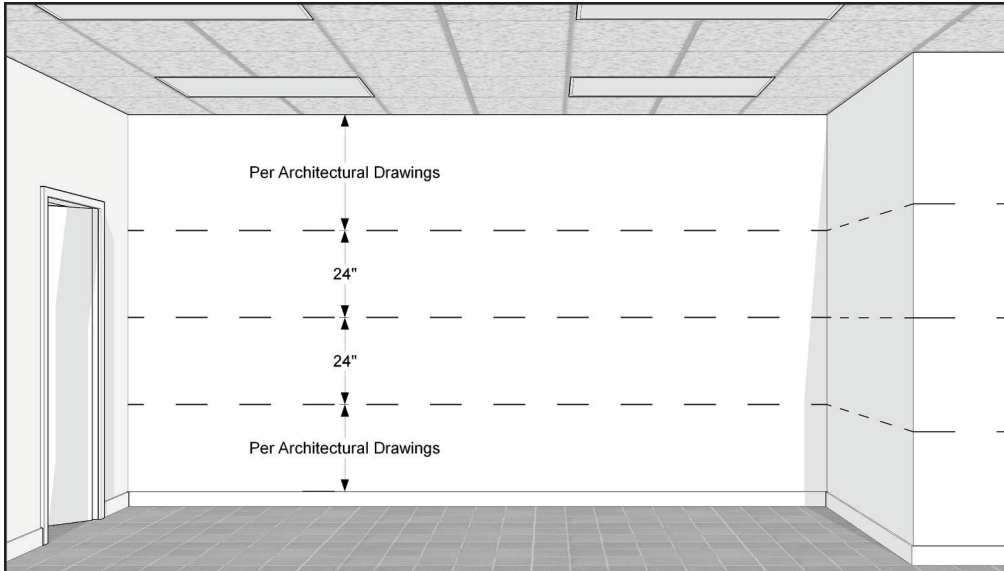

Step 1 - Layout

Refer to architectural drawings for panel and trim layout. Unless otherwise noted, try to align horizontals with door, window or corridor openings. Mark stud locations for full height and area of installation.

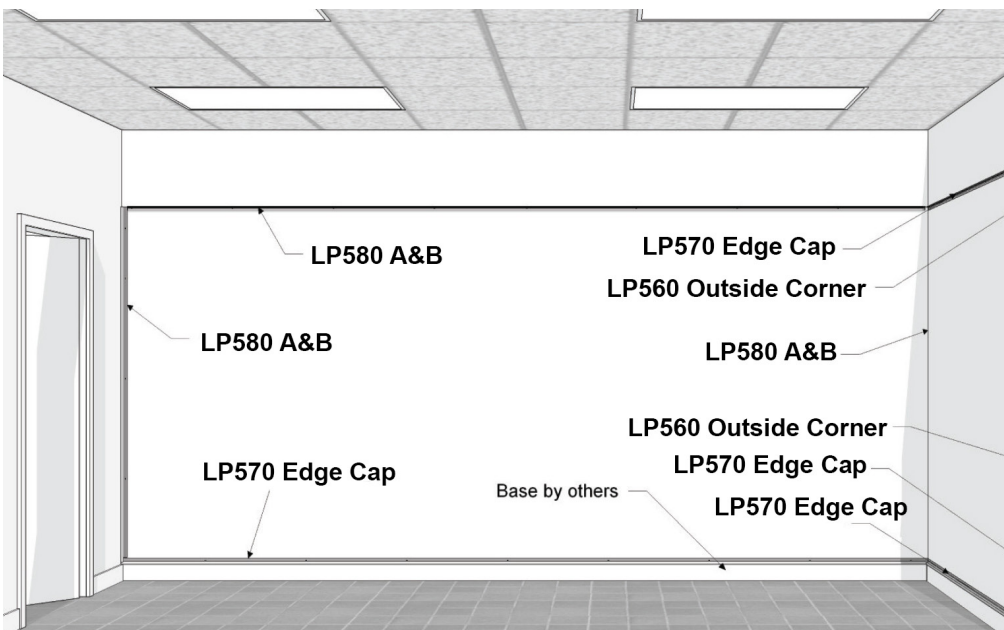

Bottom Edge:
LP570 Edge Cap

Vertical Edge:
LP580 A&B Edge Receiver
and Edge Batten

Top Edge:
LP580 A&B Edge Receiver
and Edge Batten

Inside Corner:
LP580 A&B Edge Receiver
and Edge Batten

Outside Corner:
LP560 Outside Corner

Step 2 - Install Perimeter Trim

Install bottom Edge trim first, followed by other edge and outside corner trim. Inside corners are installed as walls are completed. Refer to the Sieva Large Panel Details section. Attach trim to studs with bugle-head drywall screws, or Marlite C-109 Adhesive where studs are not available. Trim will require mitering or notching to fit at most conditions. Refer to D4 and D5 in the Sieva Large Panel Details section for more information.

Large Panel System Installation - 2

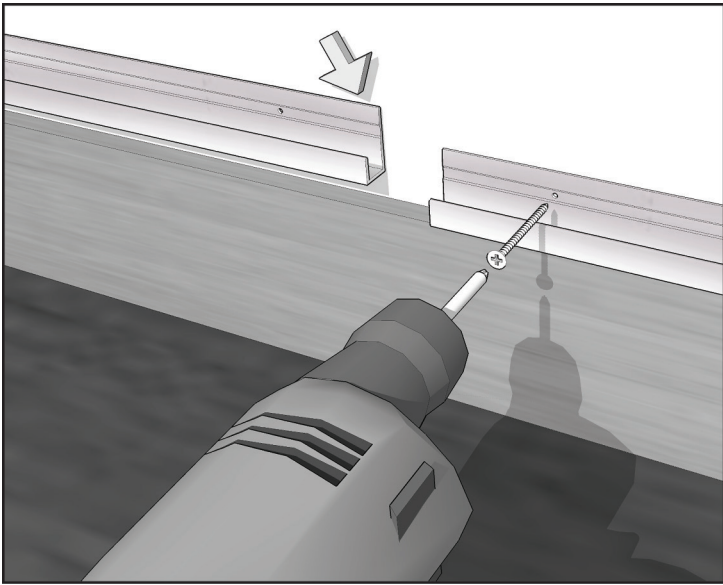

Step 3 - Install Bottom Edge

Pre-drill the bottom LP570 Edge cap at stud location. Use bugle-head drywall screws into studs to attach the trim. Where studs aren't available, use Marlite C-109 Adhesive to attach trim. Painter's tape can be used to hold the trim until the adhesive sets.

Step 4 - Apply Adhesive to Panels

Note: Dry fit and cut panels before applying adhesive. Read all instructions and warnings on the adhesive container before proceeding.

Apply Marlite C-109 Adhesive around the perimeter of the panels, keeping it in about 1" to make handling easier. Add lines of adhesive every 6"-8" across the rest of the panels, as shown at right.

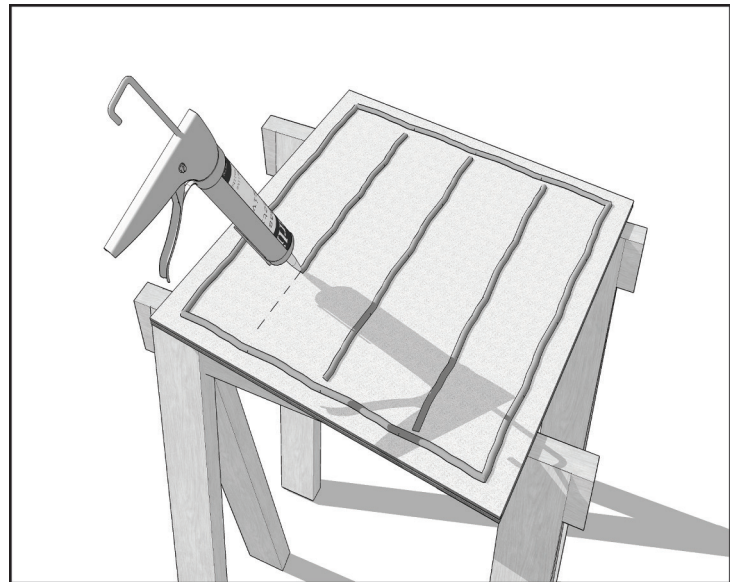

Step 5 - Install Panels & Reveals

Install panels and vertical reveal hardware. Add C-109 adhesive to the back of the reveal hardware when installing to help keep it in place as the next panel is set.

Vertical reveal hardware may be different than shown and may require notching to clear the LP570 Edge trim flange. Refer to D1 in the Sieva Large Panel Details section.

Large Panel System Installation - 3

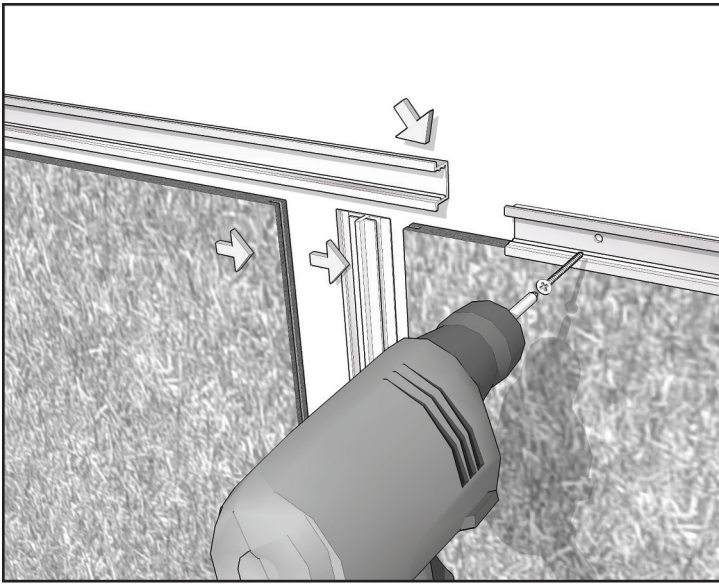

Step 6 - Horizontal Reveals

Attach horizontal reveal hardware by pre-drilling and using bugle-head drywall screws.

Horizontal and vertical reveal hardware may be different than shown. Vertical hardware may require notching to fit. Refer to D3 in the Sieva Large Panel Details section.

Step 7 -Continue Installation

Continue installing panels and reveal hardware.

Horizontal and vertical reveal hardware may be different than shown. Vertical hardware may require notching to fit. Refer to D3 in the Sieva Large Panel Details section.

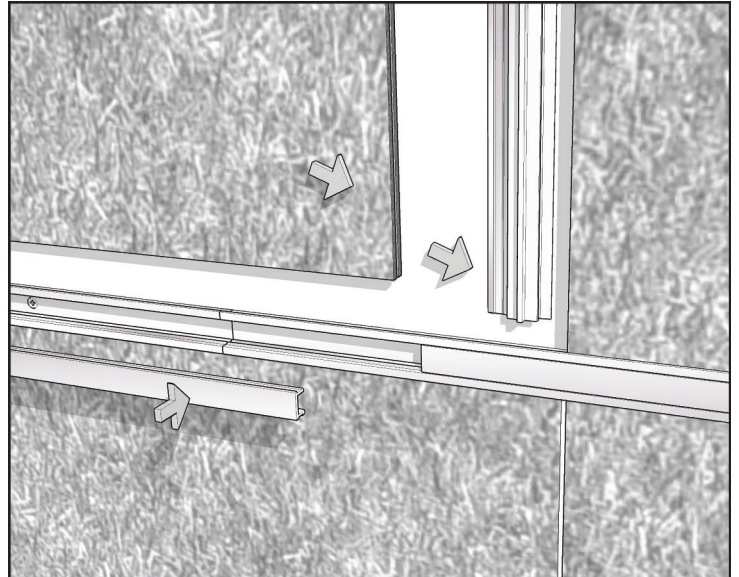

Step 8 - Top Edge Trim

Use the LP580 A&B 2-piece Edge Trim at the top of the installation.

Reveal hardware may be different than shown and may require notching to clear LP580 A&B flange. Refer to D2 in the Sieva Large Panel Details section.

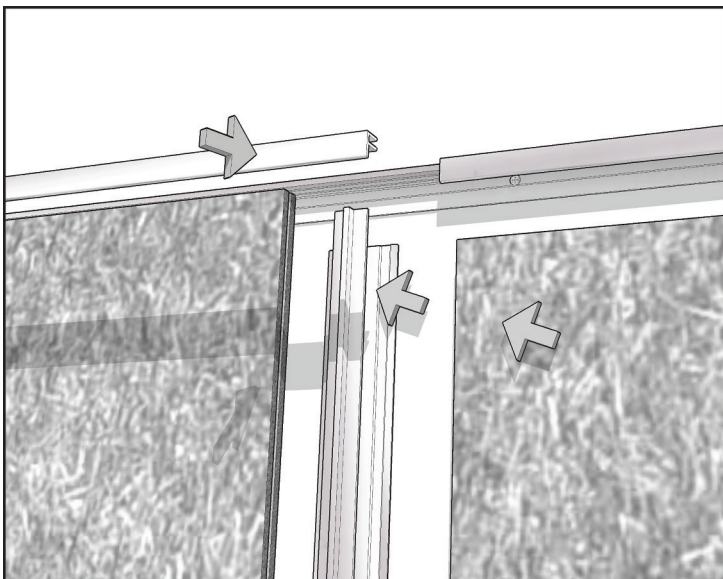

Large Panel System Installation - 4

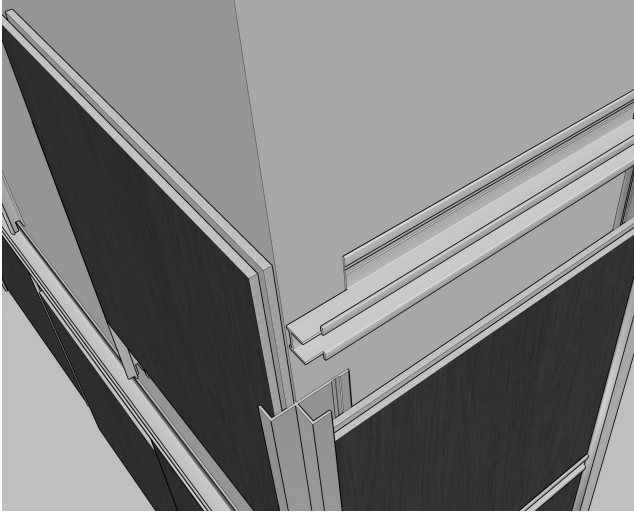

Step 9 - Outside Corners

At the outside corners, use the LP560 Outside Corner trim. Attach outside corner trim by predrilling and using bugle-head screws. Leave a 1/16" gap inside the outside corner trim to allow for panel expansion. Horizontal reveals and LP570 Edge Cap requires notching of back flange to clear LP560 Outside Corner flange. Refer to D4 in the Sieva Large Panel Details section.

Horizontal reveal hardware may be different than shown.

Step 10 - Inside Corners

At inside corners, complete a full wall installation before installing the inside corner and starting the next wall. Use the LP580 Edge Receiver and Batten for Inside Corner trim. Horizontal reveal hardware may be different than shown and may require notching to clear the LP580 Edge Receiver and Batten. Refer to D5 in the Sieva Large Panel Details section.

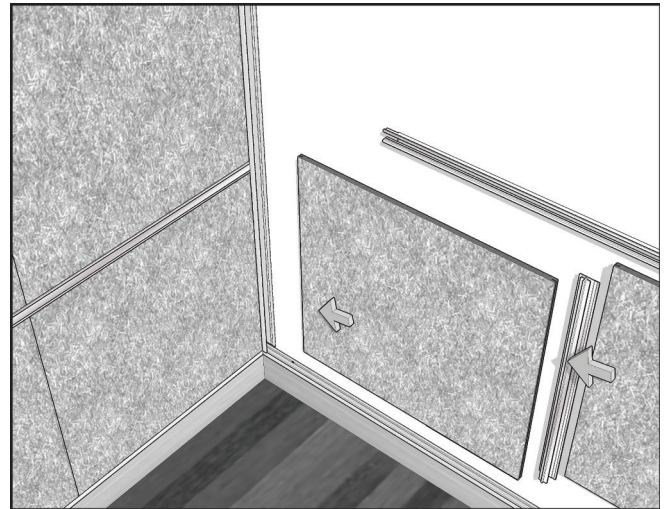

Step 11- Finished Installation

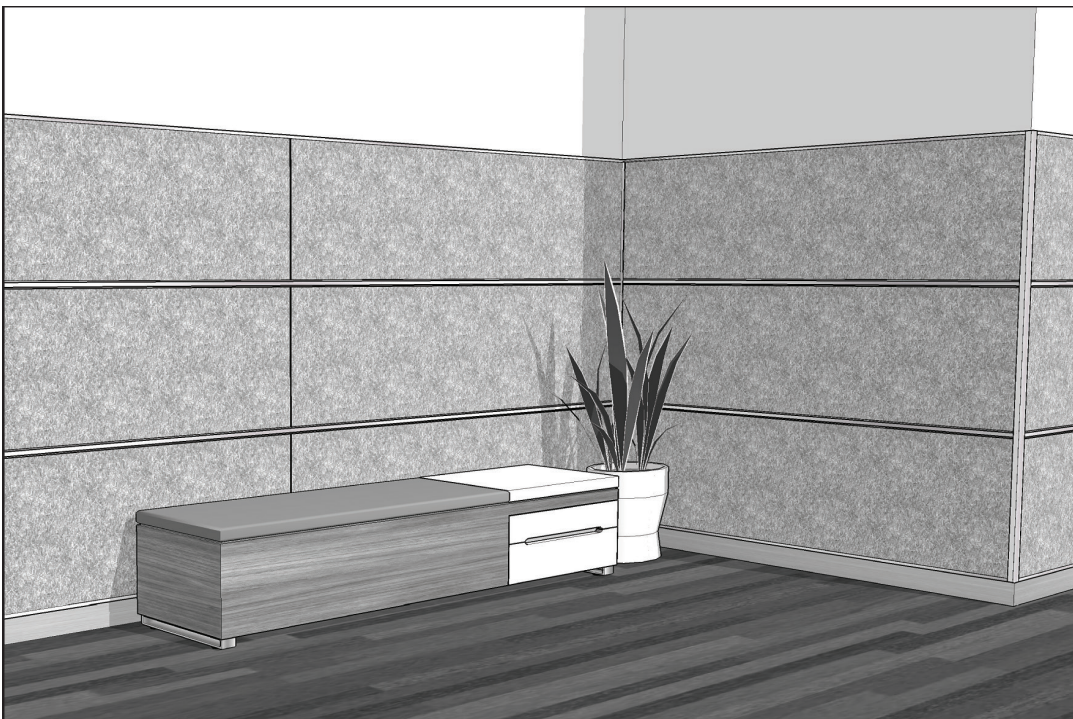

Sieva Large Panel Details

D1 - Large Panel Bottom Edge Details

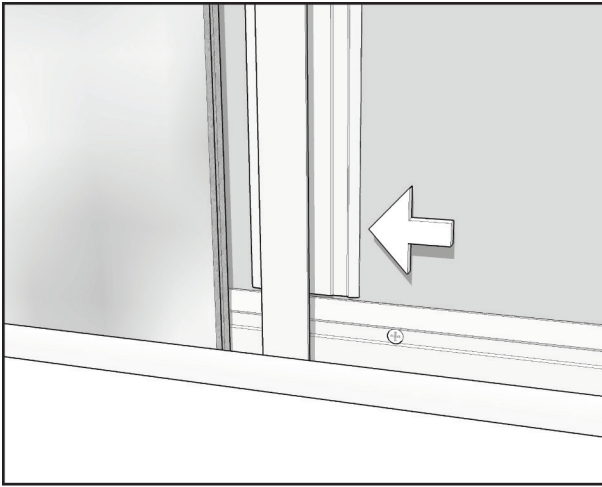

D1.1

Vertical reveals require notching of back flange as shown in figure D1.1 to clear back flange of LP570 Edge Cap. Cut back flange of reveal a minimum of 1" as shown in illustration.

D2 - Large Panel Top Edge Details

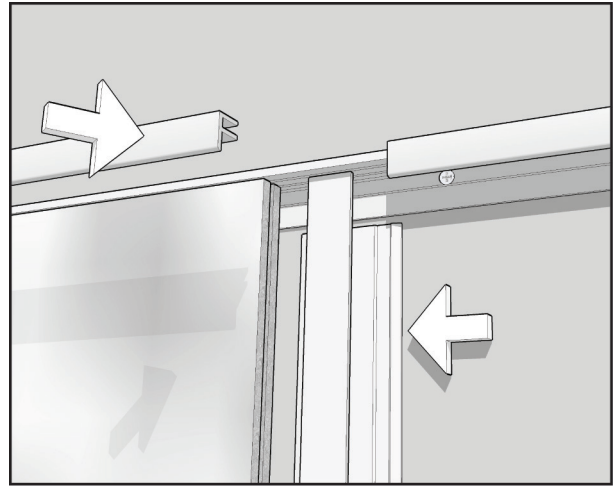

D2.1

Vertical reveals requires notching of back flange as shown in figure D2.1 to clear back flange of LP580A Edge Receiver. Snap LP580B Edge Batten onto LP580A Edge Receiver AFTER panel has been properly installed.

D3 - Large Panel Reveal Intersection Details

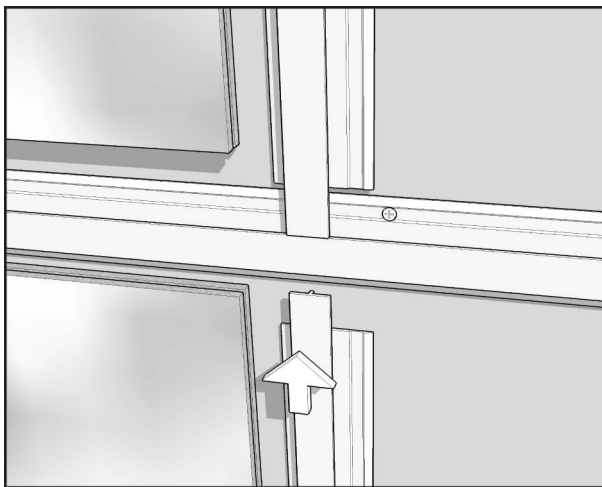

D3.1

Horizontal reveal @ Vertical reveal intersection

Notes:

Vertical reveals require notching to clear horizontal reveal flanges.

Cut back min. 3/4" to clear horizontal reveal flange where shown in the illustrations.

D4 - Large Panel Outside Corner Details

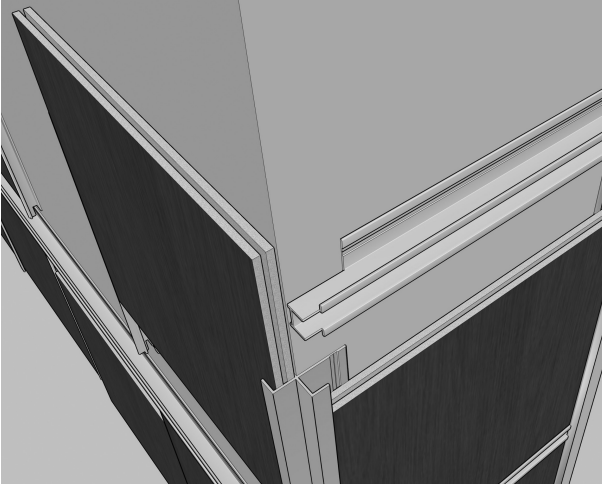

D4.1

Horizontal reveal @ LP560 Outside Corner
Notch horizontal reveal to clear LP560 flange

D5 - Large Panel Inside Corner Details

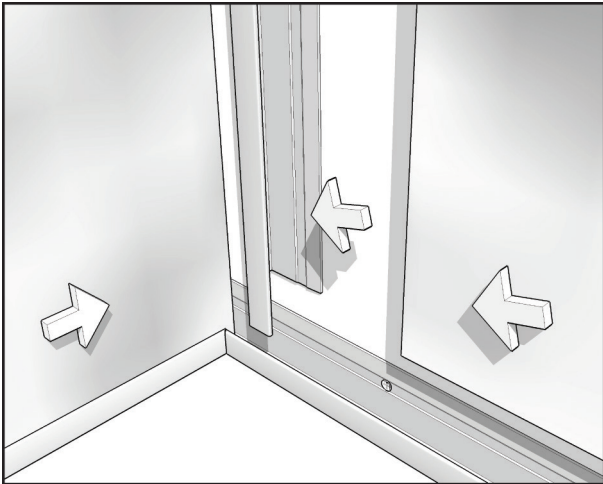

D5.1

LP580A Edge Receiver requires notching of back flange as shown in figure D5.1 to clear back flange of LP570 Edge Cap. Snap LP580B Edge Batten onto LP580A Edge Receiver AFTER panel has been properly installed.

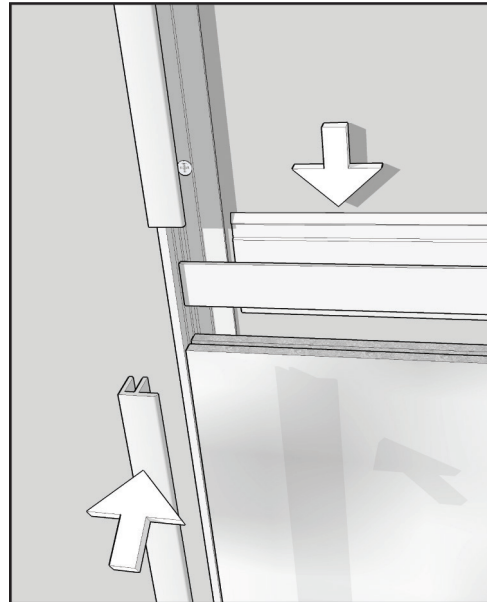

D5.2

Horizontal reveals requires notching of back flange as shown in figure D5.1 to clear back flange of LP580A Edge Receiver. Snap LP580B Edge Batten onto LP580A Edge Receiver AFTER panel has been properly installed.

This page is intentionally left blank.



1 Marlite Drive, Dover, OH 44622
1.800.377.1221
info@marlite.com